

沖縄健康バイオテクノロジー研究開発センター

既設分電盤ブレーカNo.

2F



1F

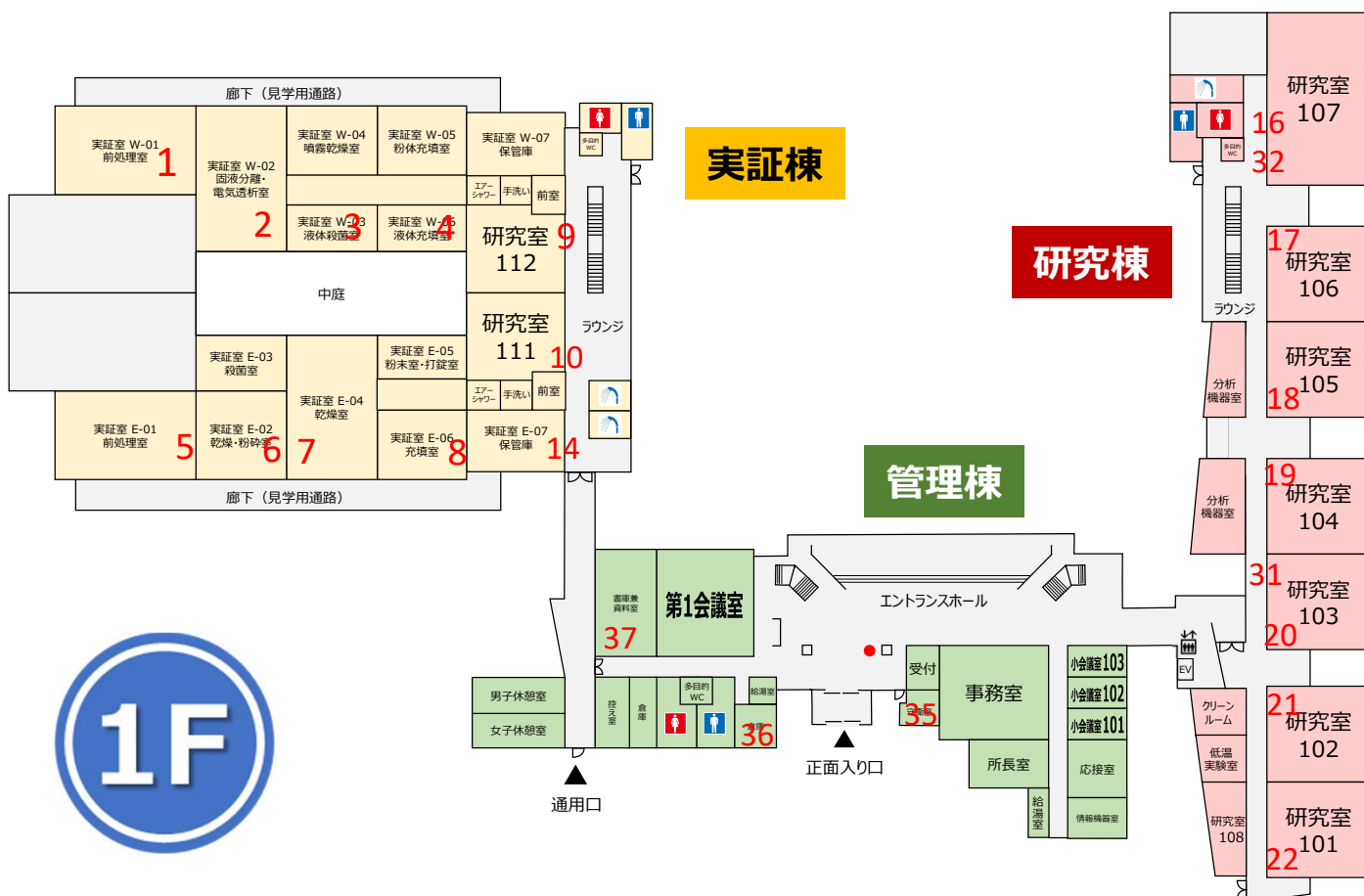

既設分電盤ブレーカ型式

No.	動力数	電灯数	分電盤名称	ブレーカ型式	メーカー	
1	1	1	P-1-1-1 (W-01)	EA403B 250A	FUJI	
			L-1-1-1 (W-01)	NF100-NCW 75A	mitsubishi	
			2	P-1-1-2 (W-02)	EA403B 350A	FUJI
				L-1-1-2 (W-02)	EA53NB 40A	FUJI
			3	P-1-1-3 (W-03)	EA403B 400A	FUJI
				L-1-1-3 (W-03)	EA53NB 50A	FUJI
			4	P-1-1-4 (W-04)	EA203B 125A	FUJI
				L-1-1-4 (W-04)	EA53NB 50A	FUJI
			5	P-1-1-5 (E-01)	EA403B 250A	FUJI
				L-1-1-5 (E-01)	EA53NB 50A	FUJI
6	P-1-1-6 (E-02)	EA603B 600A	FUJI			
	L-1-1-6 (E-02)	EA53NB 50A	FUJI			
7	P-1-1-7 (E-04)	EA403B 250A	FUJI			
	L-1-1-7 (E-04)	EA53NB 50A	FUJI			
8	P-1-1-8 (E-06)	EA203B 125A	FUJI			
	L-1-1-8 (E-06)	EA53NB 50A	FUJI			
9	P-1-1-9 (実112)	EA203B 125A	FUJI			
	L-1-1-9 (実112)	EA203NB 125A	FUJI			
10	P-1-1-10 (実111)	EA203B 125A	FUJI			
	L-1-1-10 (実111)	EA203NB 125A	FUJI			
2	11	P-1-2-1 (実202)	NF100-CW 100A	mitsubishi		
		L-1-2-1 (実202)	EA53NB 50A	FUJI		
		P-1-2-2 (実212)	EA53B 30A	FUJI		
13	12	P-1-2-2 (実212)	NF100-NCW 100A	mitsubishi		
		L-1-2-2 (実212)	EA203B 125A	FUJI		
14	13	P-1-2-3 (実201)	EA203B 125A	FUJI		
		L-1-2-3 (実201)	EA53NB 50A	FUJI		
実証棟	14	PC-12(E-07廊下)	EA203B 125A	FUJI		
		LC-12(E-07廊下)	EA53NB 50A	FUJI		
		LC-22(液体培養室)	EA53NB 50A	FUJI		
1	15	P-2-1-1 (研107)	NJ225F 125A	TOSHIBA		
		L-2-1-1 (研107)	NJ225F-E 125A	TOSHIBA		
		17	P-2-1-2 (研106)	NJ100F 75A	TOSHIBA	
			L-2-1-2 (研106)	NJ225F-E 125A	TOSHIBA	
		18	P-2-1-3 (研105)	NJ100F 75A	TOSHIBA	
			L-2-1-3 (研105)	NJ225F-E 125A	TOSHIBA	
		19	P-2-1-4 (研104)	NJ100F 75A	TOSHIBA	
			L-2-1-4 (研104)	NJ225F-E 125A	TOSHIBA	
		20	P-2-1-5 (研103)	NJ100F 75A	TOSHIBA	
			L-2-1-5 (研103)	NJ225F-E 125A	TOSHIBA	
		21	P-2-1-6 (研102)	NJ100F 75A	TOSHIBA	
			L-2-1-6 (研102)	NJ225F-E 150A	TOSHIBA	
		22	P-2-1-7 (研101)	NJ100F 75A	TOSHIBA	
			L-2-1-7 (研101)	NJ225F-E 125A	TOSHIBA	
		2	22	P-2-2-1 (研208)	NJ100F 75A	TOSHIBA
L-2-2-1 (研208)	NJ100F-E 100A			TOSHIBA		
24	P-2-2-2 (研207)			NJ100F 75A	TOSHIBA	
	L-2-2-2 (研207)			NJ225F-E 125A	TOSHIBA	
25	P-2-2-3 (研206)			NJ100F 75A	TOSHIBA	
	L-2-2-3 (研206)			NJ225F-E 125A	TOSHIBA	
26	P-2-2-4 (研205)			NJ100F 75A	TOSHIBA	
	L-2-2-4 (研205)			NJ225F-E 125A	TOSHIBA	
27	P-2-2-5 (研204)			NJ100F 75A	TOSHIBA	
	L-2-2-5 (研204)			NJ225F-E 125A	TOSHIBA	
28	P-2-2-6 (研203)	NJ100F 75A	TOSHIBA			
	L-2-2-6 (研203)	NJ225F-E 125A	TOSHIBA			
29	P-2-2-7 (研202)	NJ100F 75A	TOSHIBA			
	L-2-2-7 (研202)	NJ225F-E 125A	TOSHIBA			
30	P-2-2-8 (研201)	NF125-CW 100A	mitsubishi			
	L-2-2-8 (研201)	NJ225F-E 125A	TOSHIBA			
研究棟	30	PC-18(研103廊下)	NJ100F 75A	TOSHIBA		
		LC-18(研103廊下)	NJ100F-E 100A	TOSHIBA		
		32	PC-19(研107廊下)	NJ100F 100A	TOSHIBA	
			LC-19(研107廊下)	NJ100F-E 100A	TOSHIBA	
		33	PC-27	NJ100F 75A	TOSHIBA	
			LC-27	NJ100F-E 100A	TOSHIBA	
34	PC-28	NJ100F 100A	TOSHIBA			
	LC-28	NJ100F-E 100A	TOSHIBA			
管理棟	35	DLC/LC-14(1F事務室)	NF225 - NCW-200A	TOSHIBA		
		LC-13(1Fトイレ)	NF225-NCW-150A	TOSHIBA		
		37	L盤(書庫兼資料室)	EA203NB-150A	FUJI	
			P盤(書庫兼資料室)	EA203NB-200A	FUJI	
		38	DLC/LC-14(倉庫3)	NF-225-NCW-150A	TOSHIBA	
			LC-23(倉庫4)	NF-225-NCW-125A	TOSHIBA	
		40	研修室(L-2)	EA203NB-125A	FUJI	
研修室(P-2)	EA203B-125A		FUJI			
	35	40				
計75						